

BUTTERFLY VALVE

AL 42-A-599 / AL 43-A-599

PTFE lined

Description

AL 42-A-599 / AL 43-A-599 are butterfly valves for mounting between flanges according to DIN 1092-I, DIN 263 I and ASME B16,5. Lining and discs are coated with pure PTFE with a minimum thickness of 3 mm, that makes the valve suitable for use on aggressive media. Epoxy coated valve body. Suitable as a shut off valve or control valve, for aggressive liquids or gases. Max 10 Bar.

Connection: AL 42-A-599 - Wafer - DN 50-400
AL 43-A-599 - Lug - DN 50-300

- Shaft and disc made in a unit with "ball-shaped" sealing surfaces between disc and lining for low torque and high tightness.
- Extended neck design allows for piping insulation and enables easy access for actuator mounting.
- Mounting flange according to ISO 521 I
- Leak test according to EN 12266-1 Rate A, ISO 5208. Rate A, API 598, TAB.5.
- Max working pressure 10 bar, for flanges PN 6/10/16 or ANSI 150
- Temperature range: -40°C - +200°C
- Tightness Class A

Optional

- Lockable handlever with fixed steps
- Lever in epoxy coated steel or stainless steel
- Gear
- Electrical or pneumatic actuator
- Limit switches
- Other body coating grade
- Polished disc in stainless steel alt. conductive PTFE coated
- ATEX
- WRAS certificate for potable water
- Inspection certificate 3.1, 3.2

Kv value

DN	Opening angle				
	18°	36°	54°	72°	90°
50	-	11,3	33	81	147
65	-	21	63	160	290
80	-	33	98	238	450
100	20	54	152	362	730
125	35	93	263	626	1260
150	54	148	415	987	1990
200	120	326	915	2198	4396
250	125	338	937	2210	4500



Approvals

- CE/PED 2014/68/EU
- ATEX (group II Category 1/2GD TX)

Pressure/Temperature

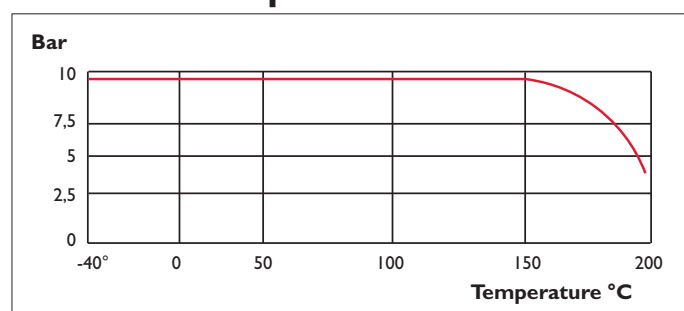

Torque at maximum working pressure - Nm

DN	50	65	80	100	125	150	200	250	300	350	400
PMA 10 bar	35	40	60	95	140	190	250	435	660	850	1050

PMA - Maximum working pressure. For pressure of 10 bar, water at 20°C. Torques are declared without safety factor. Recommended safety coefficient for the actuator installation is 1.3.

BUTTERFLY VALVE

AL 42-A-599 / AL 43-A-599

PTFE lined

Material specification

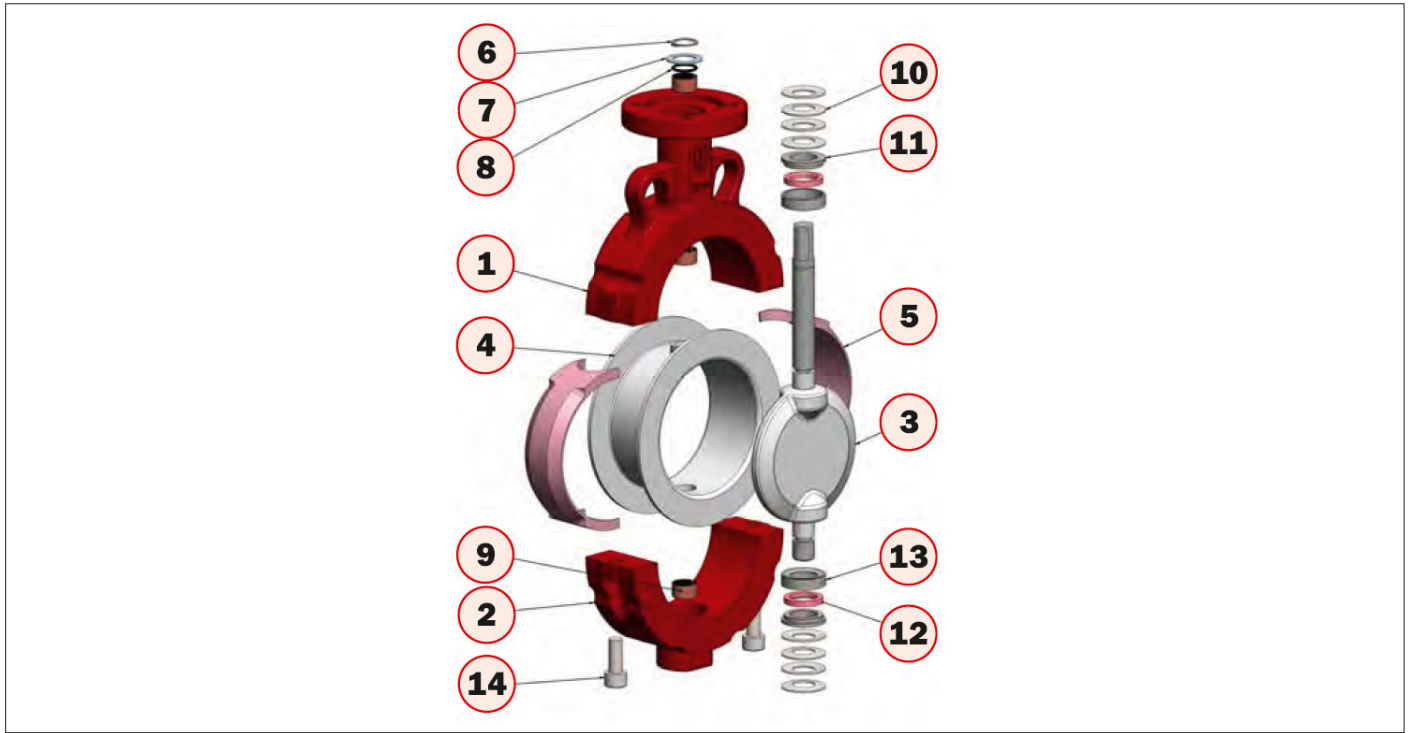

No	Part	Material
1	Body - upper part	Ductile iron 0.7043 (GGG40.3)
2	Body - lower part	Ductile iron 0.7043 (GGG40.3)
3	Disc / Stem / Pivot	Duplex stainless steel 1.4469 + PTFE
4	Seat	PTFE
5	Spring element	Silicone rubber / Viton
6	Retaining ring	Stainless steel A2
7	Washer	Stainless steel A2
8	O-ring	Silicone rubber
9	Sliding cover	Steel + CuSn10 + PTFE
10	Disc spring	Stainless steel 1.4310
11	Ring seat	Stainless steel 1.4021
12	Ring	Silicone rubber
13	Thrust washer	Stainless steel 1.4021
14	Screw	Stainless steel A4

Pure PTFE

- The parts coming to contact with work media (seat, disc) are lined with pure PTFE. Thus their long lifespan and valve quality stability are provided. Pure PTFE characteristics are high chemical resistance, toughness and flexibility, low friction coefficient, low water absorption and non-adhesiveness. All the mentioned properties provide increased protection against leakage of media. Low friction coefficient value reduces valve opening torque.
- Excellent abrasion and corrosion resistance
- Resistance to chemicals incl. strong acids and alkalines
- Resistance to solvents, alcohols, greases and oils
- Resistance to humidity and water

Valve coating

- We offers epoxy coated valve bodies providing excellent abrasion and atmosphere corrosion resistance
- Coating colour is red acc. RAL 2002, 80 µm thick
- Upon request valve bodies can be provided with special coating systems (thickness) f.e. C3, C4 etc.

Installation

The valve can be installed in horizontal and vertical lines. When mounted, the disc should be in a semi-open position. In horizontal pipes we recommend the shaft in horizontal position. The valve is maintenance free but should be operated at regular intervals depending on the installation.

BUTTERFLY VALVE

AL 42-A-599 / AL 43-A-599

PTFE lined

Dimensions - Wafer

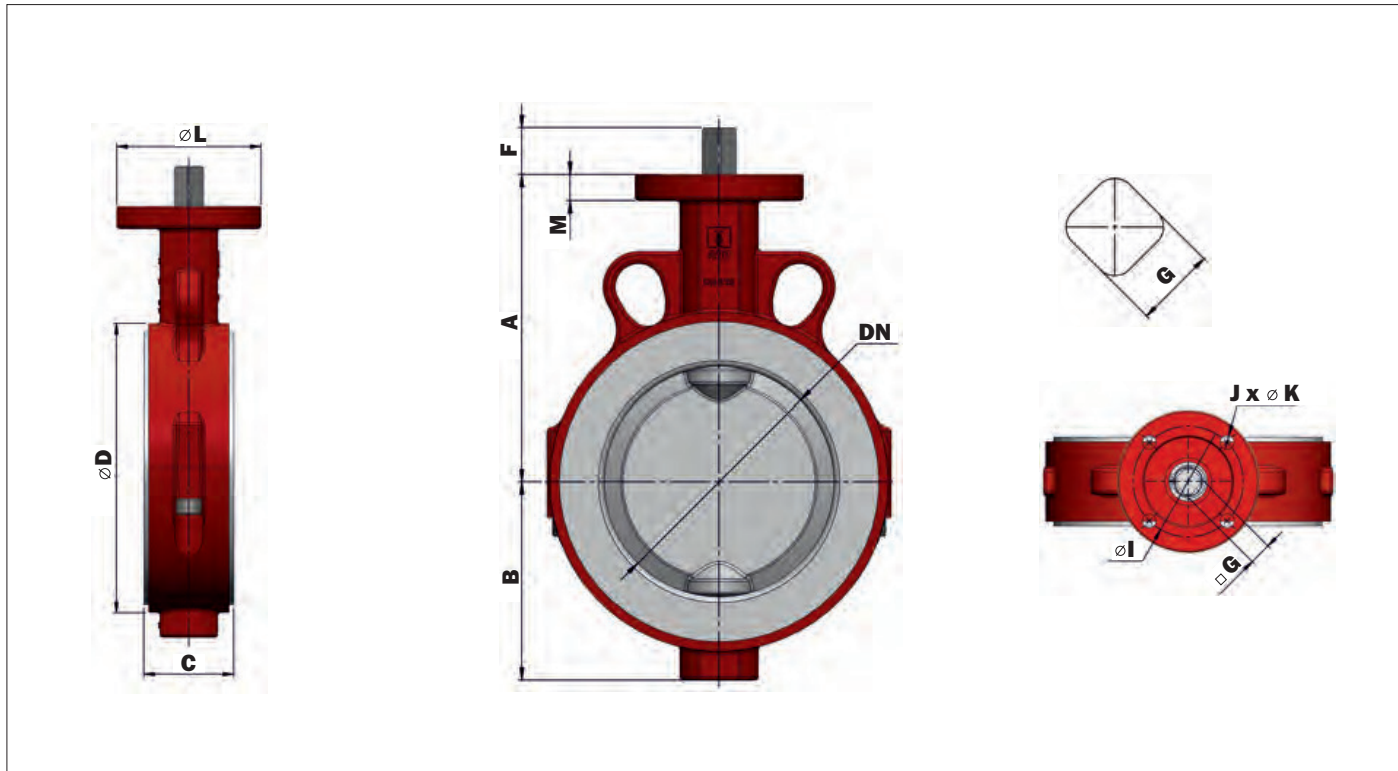

DN	50	65	80	100	125	150	200	250	300	350	400
A	120	128	135	145	164	176,5	234	274	299	331	361
B	61	74	78	90	106	126	152	186	214	245	280
C	43	46	46	52	56	56	60	70	76	78	102
D	96	115	131	152	181	207	257	314	364	408	468
F	25	25	25	25	25	25	25	31	31	42	42
G	11	11	14	14	14	14	14	22	22	27	27
I	50	50	70	70	70	70	70	102	102	125	125
J	4	4	4	4	4	4	4	4	4	4	4
K	7	7	9	9	9	9	9	12	12	14	14
L	70	70	90	90	90	90	90	125	125	155	155
M	14	14	14	14	14	14	14	18	20	20	20
ISO	F05	F05	F07	F07	F07	F07	F07	F10	F10	F12	F12
Weight kg	2,3	3,0	3,5	5,0	6,5	7,8	13,2	23,6	30,9	40,1	59,7

Lever (optional)

DN	50-65	80-125	150
A	225	270	360
B	75	75	75
Weight	1,2	1,35	1,5

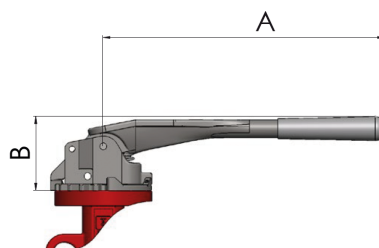

BUTTERFLY VALVE

AL 42-A-599 / AL 43-A-599

PTFE lined

Dimensions - Lug

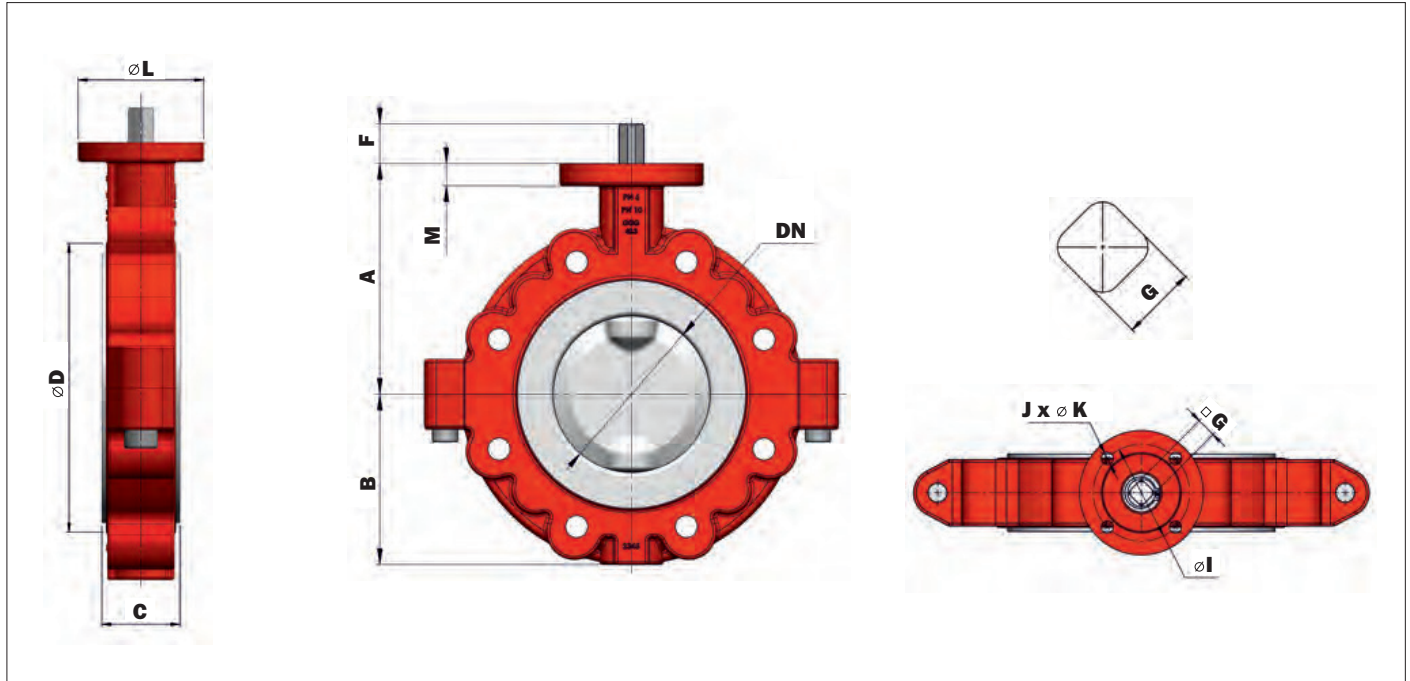

DN	50	65	80	100	125	150	200	250	300
A	120,5	128	135,5	145	164	176,5	234	274	299
B	76	85	95	107	127	138	172	197	214
C	43	46	46	52	56	56	60	70	76
D	96	115	131	152	181	207	257	314	364
F	25	25	25	25	25	25	25	31	31
G	11	11	14	14	14	14	17	22	22
I	50	50	70	70	70	70	70	102	102
J	4	4	4	4	4	4	4	4	4
K	7	7	9	9	9	9	9	12	12
L	70	70	90	90	90	90	90	125	125
M	14	14	14	14	14	14	14	18	20
ISO	F05	F05	F07	F07	F07	F07	F07	F10	F10
Weight kg	3,65	5,8	7,1	9,4	12,4	14,7	26,7	35,9	46,6

Lever (optional)

DN	50-65	80-125	150
A	225	270	360
B	75	75	75
Weight	1,2	1,35	1,5

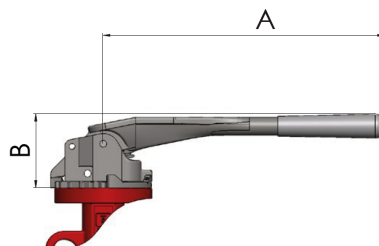

AXEL LARSSON 

Telephone +46 10 455 97 00 • sales@axel-larsson.se • www.axel-larsson.se

STOCKHOLM | GÖTEBORG | MOTALA | FALUN | UMEÅ

Head Office: Truckvägen 12, P.O. Box 805, SE-194 28 Upplands Väsby (Stockholm), Sweden.